



User's Manual

650-2200VA

Uninterruptible Power System

Audible alarm indicator

Backup Mode	Alarm every 10 seconds
Battery low	Alarm every 1 second
Overload	Alarm every 0.5 seconds
Fault	Continuous sounding

LED Indicators-

AC Mode: Green LED lighting (650VA) / The left green LED lighting & the 1st to 4th green LEDs gradually lighting indicating load leve (1600-2200VA)

Battery Mode: Yellow LED Flashing (650VA) / The left green LED flashing & the 1st to 4th green LEDs gradually lighting indicating battery capacity (1600-2200VA)

Fault Mode: Red LED Lighting

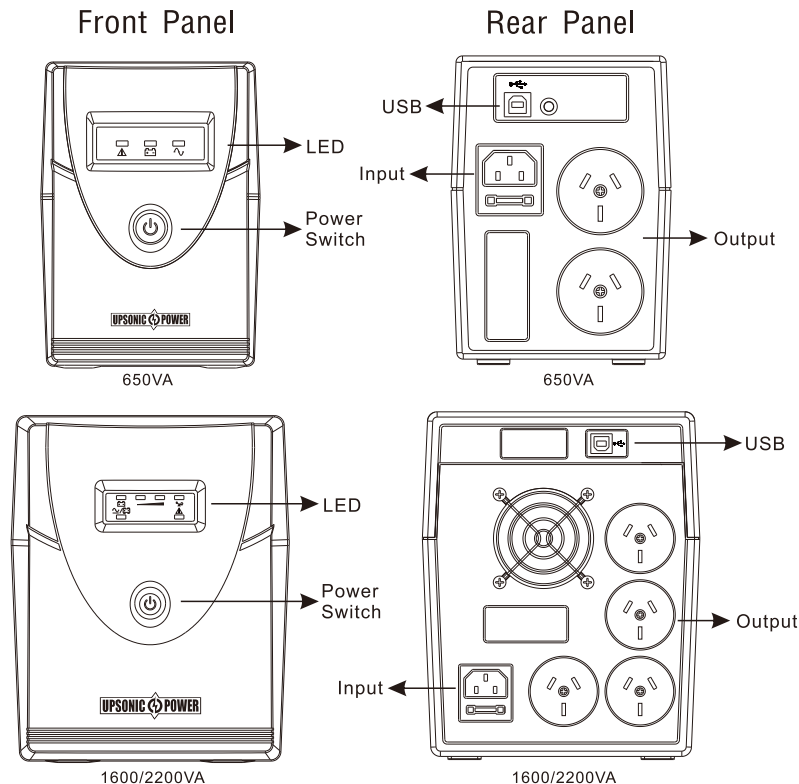

Specifications

Ratings

Capacity 650VA 1600/2200VA

Input

AC input voltage (rating) 240 Vac

Input frequency (rating) 50/60Hz

Output

AC output voltage (rating) 240 Vac

AC output voltage tolerance $\pm 10\%$ (battery mode)

Output frequency (rating) 50/60Hz

Output frequency stability $\pm 1\text{Hz}$ (battery mode)

Output waveform Simulated sine wave (battery mode)

Transfer time Typical 2-6ms

Batteries

Nominal voltage (Vdc): 12 24

Number x capacity (Ah) of batteries 1x7 2x9

Type 12V (sealed lead acid, maintenance free)

Battery recharge time for 90% capacity (hours, approximation) 6-8 hours
Autonomy: runtime in minutes 7 to 20mins (depending on load)

General

Dimensions of machine (hxwx d, mm) 142x101x298 198x158x380

Enclosure / protection IP20

Environment

Safety EN62040-1
EMC EN62040-2
Ambient temperature 0-40°C
Sound at 1 meter < 45 dB < 55 dB
Humidity 0-90%